



Silicon Valley Clean Water Commission Meeting

MAY 17, 2021

Turn on Live Captions

- ▶ To turn on live captions, go to your meeting controls and select **More actions ...** > **Turn on live captions (preview)**.

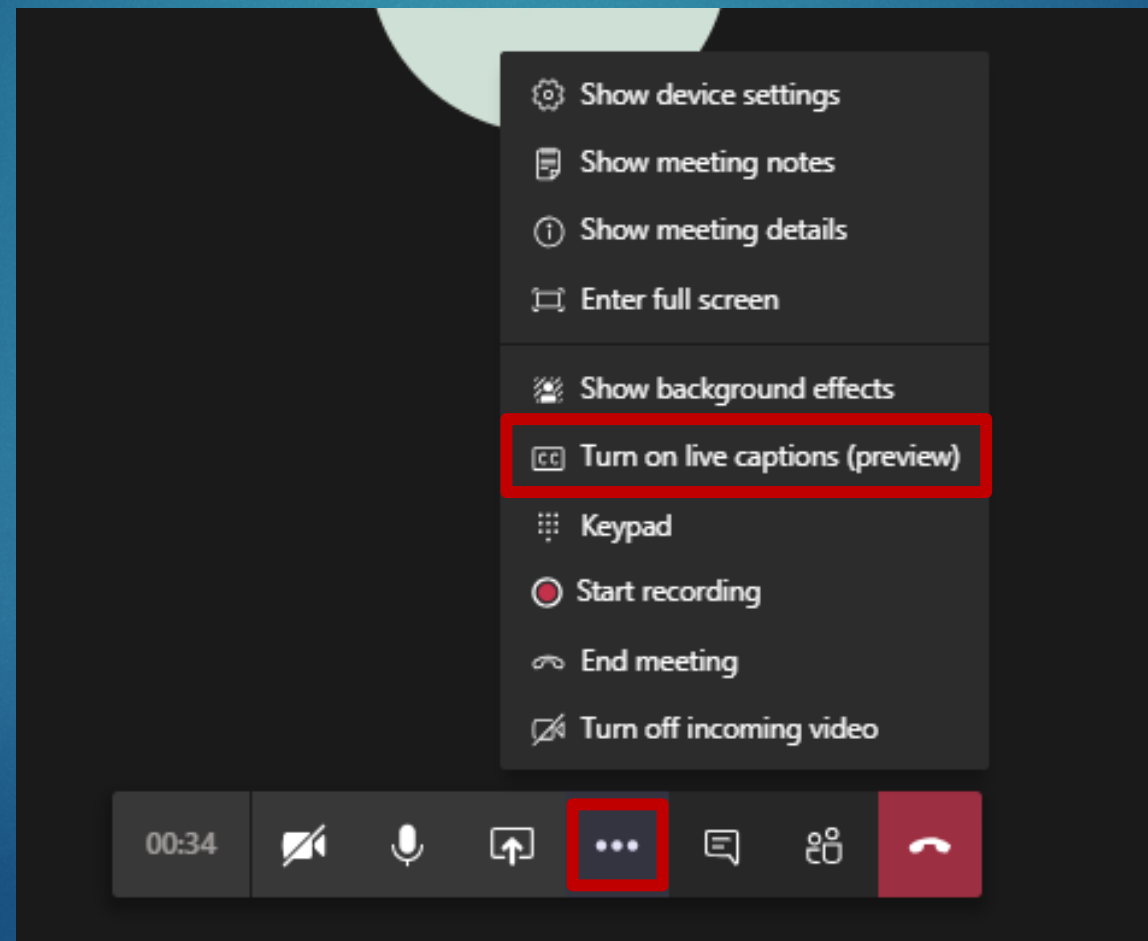

Provide Public Comment

- ▶ To provide public comment during the meeting:
 - ▶ Click on the meeting chat bubble
- ▶ Type your message into the box at the bottom of the Meeting Chat
- ▶ Note that all meeting attendees will be able to view your comment

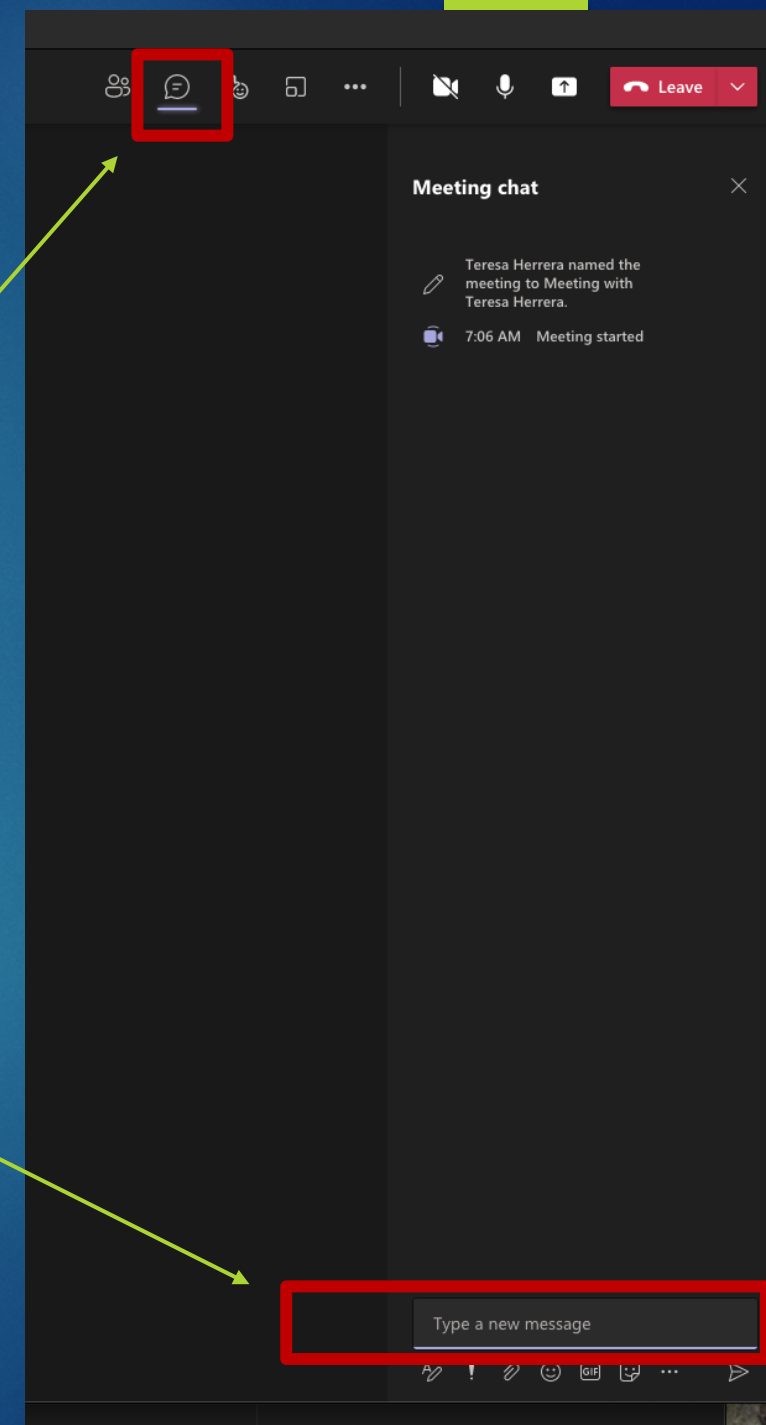







Agenda Item 5B

Manager's Report

Presentation by
CWEA President-Elect



CONGRATULATIONS WINNERS

2020 State Award Winner Presentation

www.cwea.org

CWEA: THE leading organization in California for a sustainable water environment

- 10,000 members statewide
- Since 1928
- Governed by 17 Board members
- 17 local chapters

As a membership organization, CWEA is committed to

- Empowering wastewater professionals
- Uniting the industry
- Raising the profile of wastewater treatment
- Being proven experts and a trusted industry partner

Together, we're bringing wastewater into the future

CWEA benefits for agencies and employers:

- Go-to resource for employee development: certifications, training, leadership opportunities
- Facilitation of cross-region/cross-function collaboration
- Opportunity for public recognition through awards

Awards Program

- 300 applications statewide
- 40 award categories
- Improves the professional status of workers in the wastewater industry
- Stimulates public awareness of the importance of wastewater treatment

Large Plant of the Year – First Place

Silicon Valley Clean Water
Wastewater Treatment Facility



Engineering Achievement – Third Place



Energy Demand Management System Project



THANK YOU



7677 Oakport Street Suite 1030 Oakland CA 94621
510.382.7800 | www.cwea.org





Agenda Item 8A

Gravity Pipeline Project

Contract Change Order

San Carlos Shaft



- ▶ Precautions taken to protect worker safety during shaft wall construction
- ▶ Specialized equipment used to excavate the shaft

Upcoming Construction Work

- ▶ Adit construction
- ▶ Unknown whether ammonia will be present
- ▶ Allowance item

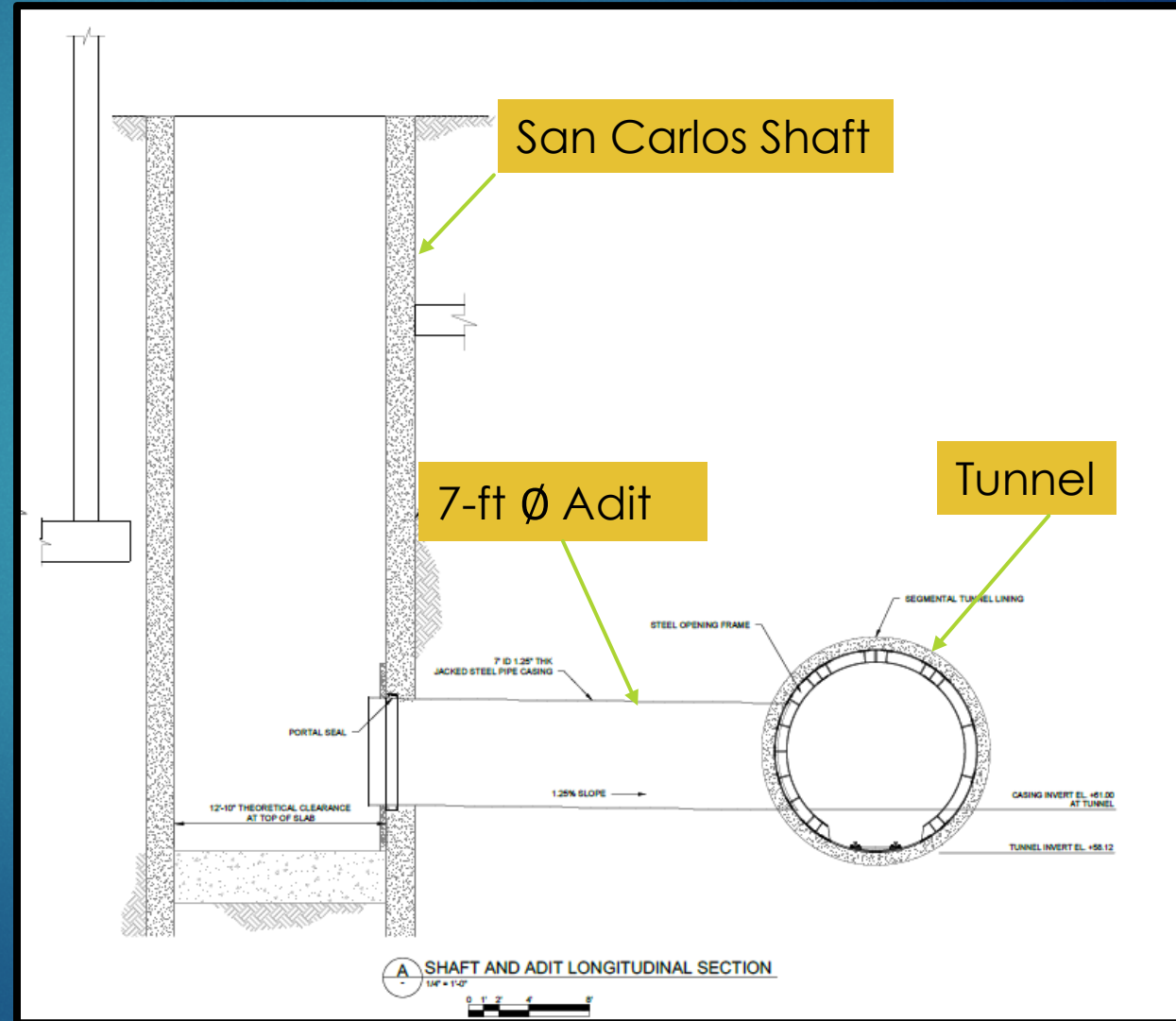

Proposed Contract Change Order

Additional Work Item	Cost	Allowance
Response to elevated ammonia levels	\$496,569	
Response to local businesses concerns	\$112,248	
Allowance for potential elevated ammonia levels during adit construction	\$0	\$420,000



Recommendation

Move approval of
Contract Change Order for
Gravity Pipeline Project
Not to Exceed \$1,028,817 –
Barnard Bessac Joint Venture





Agenda Item 8B Update on SVCW Financing Strategies

CIP and Funding Strategy

- ▶ Between 2008 and 2020, SVCW spent ~\$570 million on CIP
- ▶ Funded through 11 separate debt transactions
 - ▶ Five series of wastewater revenue bonds, plus one refunding bonds issuance
 - ▶ Three State Revolving Fund (SRF) Loans
 - ▶ One WIFIA Loan, afterwards refinanced
- ▶ This incremental approach to debt produces a low WACC
 - ▶ Weighted Average Cost of Capital, when borrowing complete, estimated at 1.8%
 - ▶ Versus traditional “bonds only” approach, saves an estimated NPV \$111 million

Remaining Debt Activity

- For known CIP projects, ~\$330 million remains to be borrowed:

Description	Estimated %	Amount	Commission Action
New SRF Loans to complete RESCU	0.90%	\$169 million	Approved
WIFIA Loan for RESCU / Construction Notes	1.75% to 2.00%	\$65 million	August 2021
WIFIA Loan for WWTP / Construction Notes	1.75% to 2.00%	\$71 million	August 2021
Future Bond Issuance	3.00% to 4.00%	\$25 million	2024

- Additionally, a \$75 million Line of Credit provides liquidity as needed and may be adjusted depending on timing

Conclusion

- ▶ Information presented to Members' staff in April
- ▶ Commenced preparation of disclosure documents*
- ▶ Anticipate draft materials to Members by end of June
- ▶ Action requested by Members' Councils/Board in August

*for WIFIA Loans and Notes





Agenda Item 8C Commission Policy – Remote Workplace



“Return to Work” is THE hot topic for Employers



Remote & Onsite Work Conjoin

- ▶ Significant #s of Workers have worked from remote locations
 - ▶ Health and Safety
 - ▶ Productivity and Effectiveness
- ▶ Considerations for Providing Hybrid Workplace
 - ▶ Employee Health and Safety
 - ▶ What's Worked and What's Not Worked
 - ▶ Ability to Adapt (Agency and Individuals)
 - ▶ Onsite Facilities' Configuration
 - ▶ Employee Retention

Remote & Onsite Work

▶ Advantages

- ▶ Employee Retention
- ▶ High Levels of Efficiency

▶ Possible Disadvantages

- ▶ Public Perception
- ▶ Culture Degradation

▶ Meeting SVCW's Mission & Vision

- ▶ Protecting Public Health/Environment by Handling Wastewater Safely, Reliably, Efficiently, and Responsibly
- ▶ Collaborative, Respectful, Ethical, with High Levels of Technical Expertise

Remote & Onsite Work – When?

▶ Timing

- ▶ June 15?
- ▶ 80% Vaccination?

OR

- ▶ Don't use a date at all and, instead, consider Worksite & Job Function

▶ Having Policy in place will ensure a proactive response

Recommendation

Move adoption of Resolution
Approving and Adopting
Commission Policy No. 2021-01
Remote Workplace



Thank You

